

HYDRAULIC INFRASTRUCTURES

AQUEDUCTS AND SEWERS

TITLE: DRINKING WATER FEEDING SYSTEM, STARTING FROM THE DESALINATION PLANT - CAP DJINET (ALGERIA)

DESCRIPTION: the desalination plant of Cap Djinet is designed for a flow of 100 000 cubic meters/day and feeds a feeding water plant of drinking water about 60 km length (DN1200 – 700 – 500 – 400) with several reservoirs (total capacity over 64 000cm).

CUSTOMER: Società Italiana Condotte d'Acqua SPA – (Italy)

TOTAL AMOUNT OF WORKS: € 80.000.000,00

YEAR: 2010 (preliminary pipeline plan)

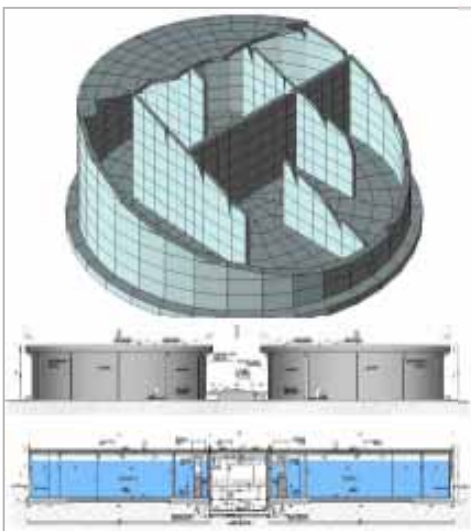



Phase of pipeline laying

40.000 mc Tank



40.000 mc tank